

Onanon's *MagConnect™ | Hero* is performance engineered to be the most intuitive interconnect in the world. Its unique magnetic safety latch feature is ideal for medical applications, where time, precision, and quality are most critical. Additional suitable markets are within the automotive, aerospace and industrial industries.

- **2 to 20 pin capacity**
- **Intuitive and Self-Mating**
- **Magnetic Safety de-latching**
- **Customizable for reusable or single use applications**
- **Easily add components such as eeproms, resistors and capacitors**

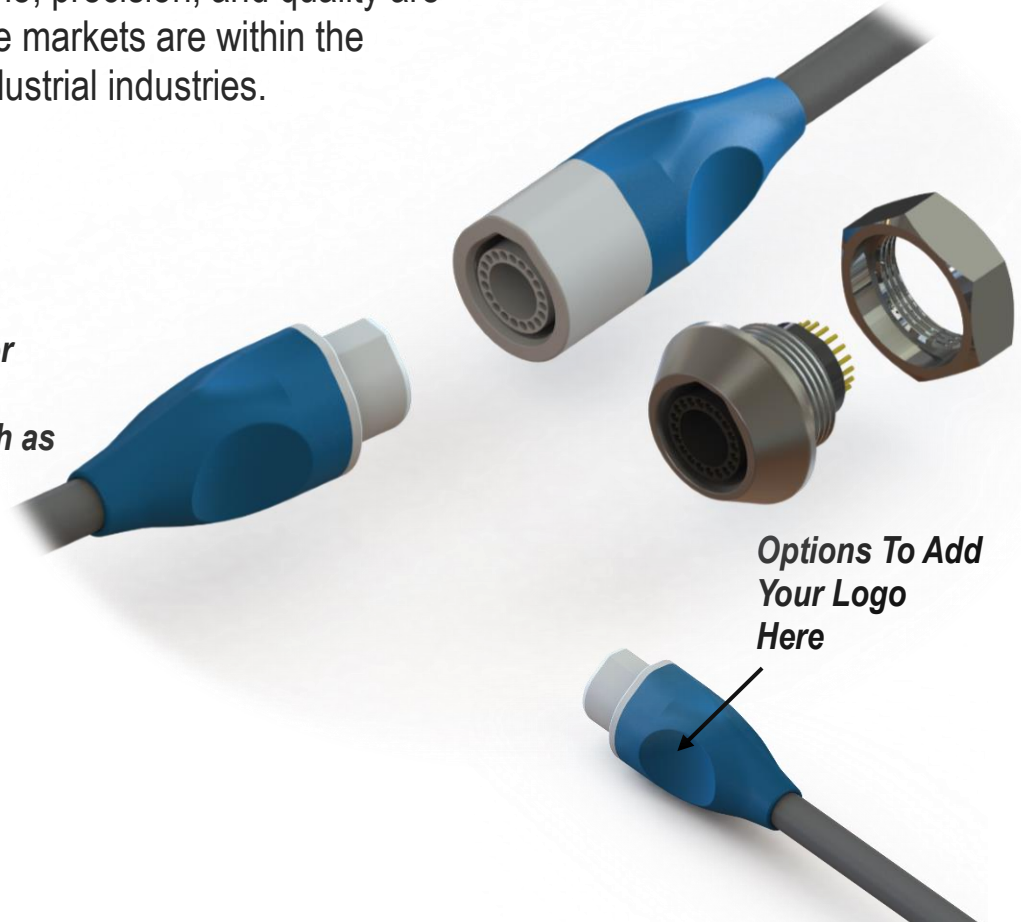

Specifications

Mechanical

Mating Type: Magnetic
Mating Cycles:
Plug: 5000 Min.
Panel Receptacle: 10k Min.
In-Line Receptacle: 5k Min.
Mating Forces:
Insertion: Magnetic
Removal (PR): 4.5 lbf
Removal (IR): 3.5 lbf

Electrical

Operating Voltage:
 1kVAC and 1.5kVDC
Operating Current: 3A

Environmental

Sterilizable: Gamma, EtO
Chemical Resistance: Common cleaning solvents
Finger Safety: IEC 60601-1
Storage & Operating Temp:
 0-150°C

Compatibility

Contacts: 20 pins
Plug Cable Assembly
Accepted Wire Gauges: 26-50 AWG
Cable Jacket OD: 0.286" Max
Contact Termination: Solder
In-Line Receptacle Cable Assembly
Accepted Wire Gauges: 26-50 AWG
Cable Jacket OD: 0.286" Max
Contact Termination: Solder



Self-Mating

Intuitive tear drop allows for easy alignment and mating



Sterilizable

Chemical-Resistant Materials are Easy to Clean and Withstand Repeated Wipe-downs using Common Hospital Disinfectants



Magnetic Safety Latch

Customizable low to high retention force to meet desired need for a reliable, safe connection

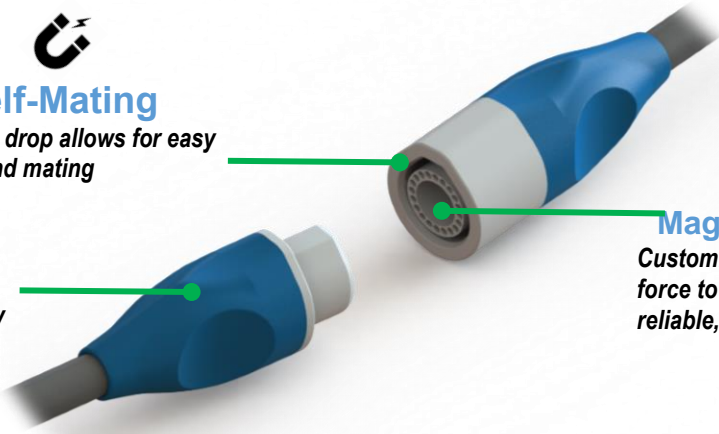

Dimensions

Plug

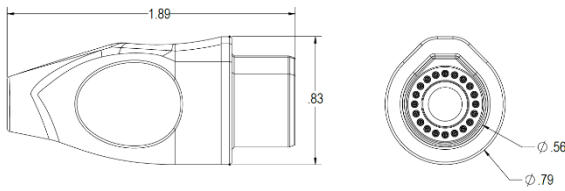

Panel Mount Receptacle

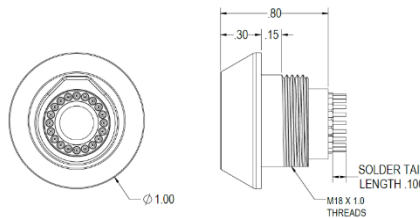

Inline Receptacle

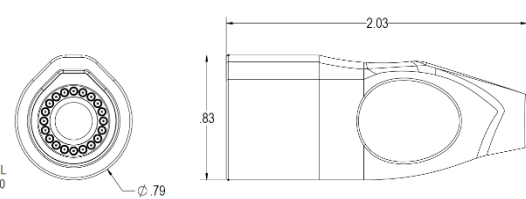

Recommended Cable Specifications

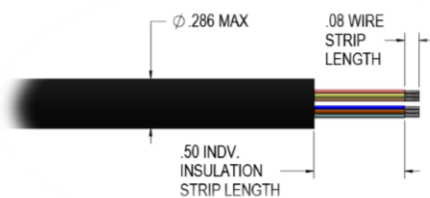

Recommended PCB or Flex Dimensions

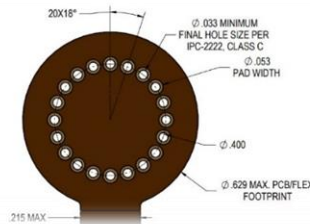

Recommended Panel Cutout

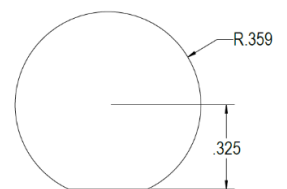

Units are in inches
Contact us for unspecified dimensions

Materials & Assembly

Male Plug Cable Assembly

Plug Housing: Thermoplastic Polyester
Retaining Cap: Thermoplastic Polyester
Pins: Gold Plated Brass Alloy
Magnet: Nickel Plated Neodymium
Slip-On Boot: Thermoplastic Polyurethane

Male Plug Cable Assembly

Plug Housing: Thermoplastic Polyester
Retaining Cap: Thermoplastic Polyester
Pins: Gold Plated Brass Alloy
Magnet: Nickel Plated Neodymium
Slip-On Boot: Thermoplastic Polyurethane

Panel Mount Receptacle

Insulator Insert: Thermoplastic Polyester
Metal Shell: Chromium Plated Brass Alloy
Pins: Gold Plated Brass Alloy
Magnet: Nickel Plated Neodymium

Required Assembly: Assemble connector body after terminating wires

Required Assembly: Assemble connector body after terminating wires

Required Assembly: Solder a PCB or flex assembly.